

Medisca MD[®] Ophthalmic Dropper Bottles

Filling Instructions

To Fill

1. Ensure that the inner plug is installed within the screw cap.

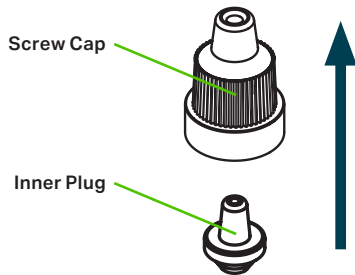

2. Fill the bottle.

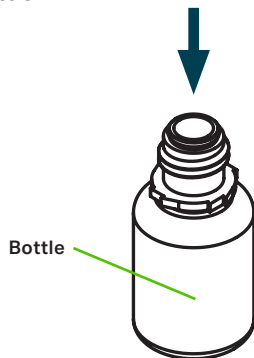

3. Obtain the screw cap from the tray and place your thumb and index finger on both the ribbed section of the screw cap and tamper seal. Slowly twist in the clockwise direction while ensuring to firmly press down on the cap.

Note. It is not recommended to dispense the MD Ophthalmic dropper if the tamper seal is broken.

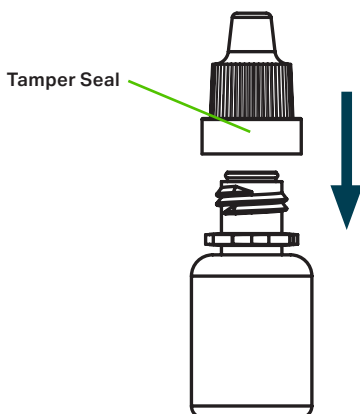

To Use

1. To open the MD Ophthalmic Dropper, gently twist the screw cap in the counter-clockwise direction while placing your fingers on the ribbed section of the cap.



2. Remove the screw cap, invert the bottle and compress to dispense.

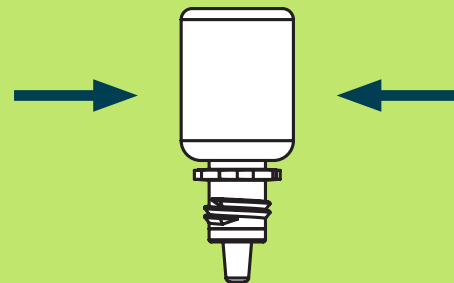

For More Information

USA 1-800-932-1039 medisca.com
CAN 1-800-665-6334 medisca.ca
AUS 1300 786 392 medisca.com.au